



Aged Brass (Finish ID:4)

LIVINGSTON EDGE PULL

	Item Code	Size (mm & Inches)	Material	Size (Inches)				Fig.
				A	B	C	D	
1	PL.1022.96.XX	96mm (3.78")	Brass	4.78	0.98	3.78	0.98	1
2	PL.1022.128.XX	128mm (5.04")	Brass	6.04	0.98	5.04	0.98	1
3	PL.1022.160.XX	160mm (6.3")	Brass	7.3	0.98	6.3	0.98	1
4	PL.1022.7".XX	177.8mm (7")	Brass	8	0.98	7	0.98	1
5	PL.1022.8".XX	203.2mm (8")	Brass	9	0.98	8	0.98	1
6	PL.1022.9".XX	228.6mm (9")	Brass	10	0.98	9	0.98	1
7	PL.1022.10".XX	254mm (10")	Brass	11	0.98	10	0.98	1
8	PL.1022.12".XX	304.8mm (12")	Brass	13	0.98	12	0.98	1
9	PL.1022.15".XX	381mm (15")	Brass	16	0.98	15	0.98	1
10	PL.1022.17".XX	431.8mm (17")	Brass	18	0.98	17	0.98	1

"XX" in item code denotes Finish ID.

This product is Supplied with Mounting Kit including with the Order

	Item Code	Size (mm & Inches)	Material	Size (Inches)				Fig.
				A	B	C	D	
11	PL.1022.18".XX	457.2mm (18")	Brass	19	0.98	18	0.98	1
12	PL.1022.19".XX	482.6mm (19")	Brass	20	0.98	19	0.98	1
13	PL.1022.24".XX	609.6mm (24")	Brass	25	0.98	24	0.98	1
14	PL.1022.36".XX	914.4mm (36")	Brass	37	0.98	36	0.98	2

"XX" in item code denotes Finish ID.

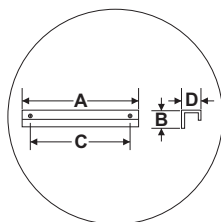

FIG. 1

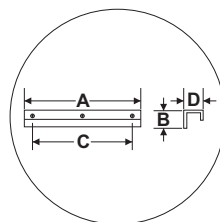
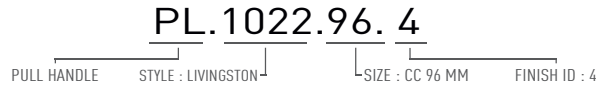

FIG. 2

This product is Supplied with Mounting Kit including with the Order

How to Order



Livingston Edge Pull Finish Options

Base Material : Brass	Standard Finishes (2-3 Weeks Delivery)
 Bright Chrome (Finish ID:2)	 Brush Nickel (Finish ID:3)
 Aged Brass (Finish ID:4)	 Unlacquered Polished Brass (Finish ID:7U)
 Polished Nickel (Finish ID:8)	 Satin Brass (Finish ID:13)
Base Material : Brass	Custom Finishes (3-4 Weeks Delivery)*
 Lacquered Polished Brass (Finish ID:7L)	 Matte Black (Finish ID:19)
 Satin Chrome (Finish ID:24)	 Graphite (Finish ID:61)
 Titanium (Finish ID:79)	 Ombre (Finish ID:92)
	 Brush Chrome (Finish ID:95)

Door Material	Door Thickness
1. Wood	3/4", 1", 1 1/4", 1 1/2", 1 3/4", 2", 2 1/4", 2 1/2"
2. Metal	3/4", 1", 1 1/4", 1 1/2", 1 3/4", 2", 2 1/4", 2 1/2"
3. Glass	3/4", 1"

- Custom finishes cannot be returned or refunded. We are unable to accept cancellations for custom finish order unless within 48 hours of the order being placed.
- We have uniform pricing for all non-hammered finishes listed above as long as base material and size is same.
- Contact us for customized finishes, refer pages F1, F2, F3 & F4 for finish glossary.
- Backplate options refer page DBP1-1 to DBP2-1.