



Matte Black (Finish ID : 19)

BREU D HANDLE

	Item Code	Size (mm & Inches)	Material	Size (Inches)				Fig.
				A	B	C	D	
1	DH.860.4".XX	101.6mm (4")	Brass	4.28	0.28	4	1.18	1
2	DH.860.6".XX	152.4mm (6")	Brass	6.28	0.28	6	1.18	1
3	DH.860.8".XX	203.2mm (8")	Brass	8.28	0.28	8	1.18	1
4	DH.860.12".XX	304.8mm (12")	Brass	12.28	0.28	12	1.18	1

"XX" in item code denotes Finish ID.

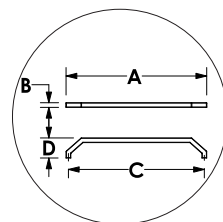
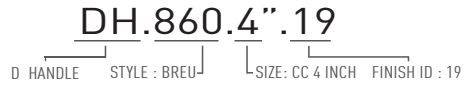

FIG. 1

This product is Supplied with M4x25mm screws.
This product is Supplied with M4x45mm break off screws.

How to Order



Breu D Handle Finish Options

Base Material : Brass	Standard Finishes (2-3 Weeks Delivery)
 Bright Chrome (Finish ID:2)	 Brush Nickel (Finish ID:3)
 Aged Brass (Finish ID:4)	 Unlacquered Polished Brass (Finish ID:7U)
 Polished Nickel (Finish ID:8)	 Satin Brass (Finish ID:13)
Base Material : Brass	Custom Finishes (3-4 Weeks Delivery)*
 Lacquered Polished Brass (Finish ID:7L)	 Matte Black (Finish ID:19)
 White Epoxy (Finish ID:42)	 Graphite (Finish ID:61)
 Titanium (Finish ID:79)	 Brush Chrome (Finish ID:95)

- Custom finishes cannot be returned or refunded. We are unable to accept cancellations for custom finish order unless within 48 hours of the order being placed.
- We have uniform pricing for all non-hammered finishes listed above as long as base material and size is same.
- Contact us for customized finishes, refer pages F1, F2, F3 & F4 for finish glossary.
- Backplate options refer page DBP1-1 to DBP2-1.